

CLARE NASH ARCHITECTURE



NEWSLETTER

This newsletter will bring you Clare Nash Architecture's news and blog posts on a monthly basis. Please feel free to forward to anyone who might take an interest.

BRACKLEY OLD FIRE STATION

With the purchase of the Old Fire Station by Brackley Town Council, Clare Nash submitted plans to encourage people to speak out about what uses they would like in the building. We received a lot of comments from people who would otherwise not have known there was a consultation in process.

MAKE SURE YOU ARE WELL INSULATED TO SAVE MONEY WITH AN AIR SOURCE HEAT PUMP

With the new Renewable Heat Incentive launched recently, I thought I would write a brief post about air source heat pumps. If you are thinking of replacing a boiler running on oil any time soon, then it would certainly be worth looking at replacing it with an air source heat pump. An engineer came to my house recently to service mine and told me that you can save as much as two thirds on your heating bill when compared to oil. This is certainly what we are experiencing but then we have the ideal conditions for it to be efficient. We live in a very well insulated new build home and the heat pump runs water through oversized radiators at low temperature. If your house is poorly insulated then you will need to run your ASHP at a higher temperature which will make it inefficient and expensive to run as otherwise the majority of heat will disappear through the walls before you feel it in your home. This is why oil fired radiators feel hot to touch, at least that way some of this heat will stay in your home! ASHP's also run very well combined with underfloor heating as this works best at low temperature.

MAY 2014 CONTENTS

Latest News and Blog Posts

About

Contact

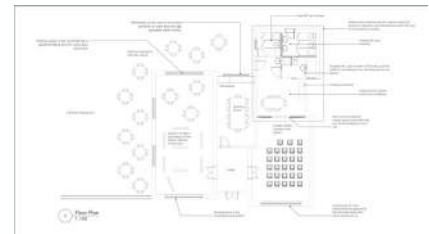

To see the alternative plans for Brackley Fire Station see my post [here](#). If you would like to add your views, please do send them in to a Brackley Town Councillor.

CLARE NASH ARCHITECTURE



NEWSLETTER

Therefore if you are thinking of installing a heat pump, it is best to ensure you have a well insulated house or refurbish to achieve this. With the right amount of insulation you will also qualify for the RHI fund that I wrote about in a previous post. With an average cost of £8000* to install a heat pump, you could recoup most of this over a 7 year period from the government.

*Heat Pumps the Great Debate; home building and renovating magazine; April 2014

GET PAID TO INSTALL RENEWABLES

The Renewable Heat Incentive is a government scheme where you actually get paid to install a renewable heat generation technology. So far these include Air Source Heat Pumps, Ground Source Heat Pumps and Solar Thermal (solar hot water heating), but there are plans to include Solar Photovoltaic (solar electric) panels to the scheme. For more information see my post [here](#).

RAINWATER HARVESTING

Read about a client's experience with installing and using a rainwater harvesting tank for flushing toilets, washing clothes and garden use on my post [here](#).

CONTACT

email: info@clarenasharchitecture.co.uk
phone: 01295 768359
mobile: 07790943803
web: www.clarenasharchitecture.co.uk



ABOUT

Clare Nash is a chartered architect. Growing up on a farm and living in a village makes her ideally placed to focus on rural buildings, energy efficiency and conservation. She has studied vernacular architecture in the UK and abroad, completing a masters at Oxford Brookes University. CNA design focus takes inspiration from the vernacular, focusing on people, site, climate, location, context, sustainable and beautiful materials to produce buildings that sit well in their surroundings and suit the people who reside in them.